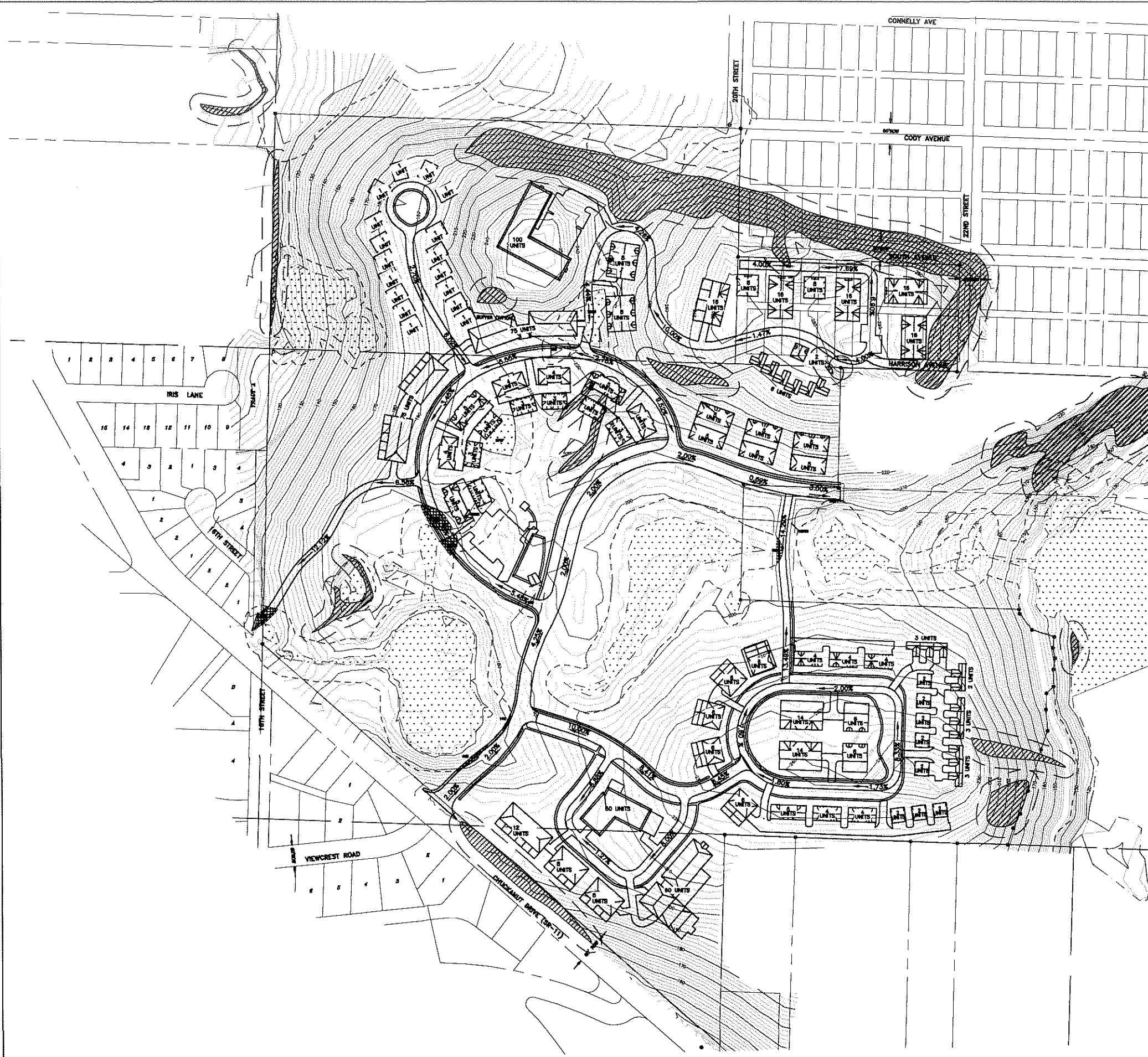

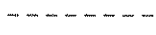
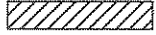
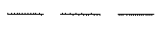


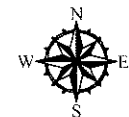
W:\BELLINGHAM\PROJECTS\11911001\02\CAD\1191100102 Fig 7.dwg\TAB-LANDSCAPE MODIFIED BY THICHAUD ON FEB 12, 2009 - 10:15



Legend

-  Wetland
-  Wetland Buffer
-  Area of 40% Slope or Greater
-  30' Slope Buffer

DRAFT



Notes

1. Geologic conditions inferred from subsurface exploration, site reconnaissance, and topographic features.
2. The locations of all features shown are approximate.
3. This drawing is for information purposes. It is intended to assist in showing features discussed in an attached document.  
GeoEngineers, Inc. cannot guarantee the accuracy and content of electronic files. The master file is stored by GeoEngineers, Inc. and will serve as the official record of this communication.  
Reference: p-lay-ALT-2A.dwg provided by Ronald T. Jepson & Assoc.

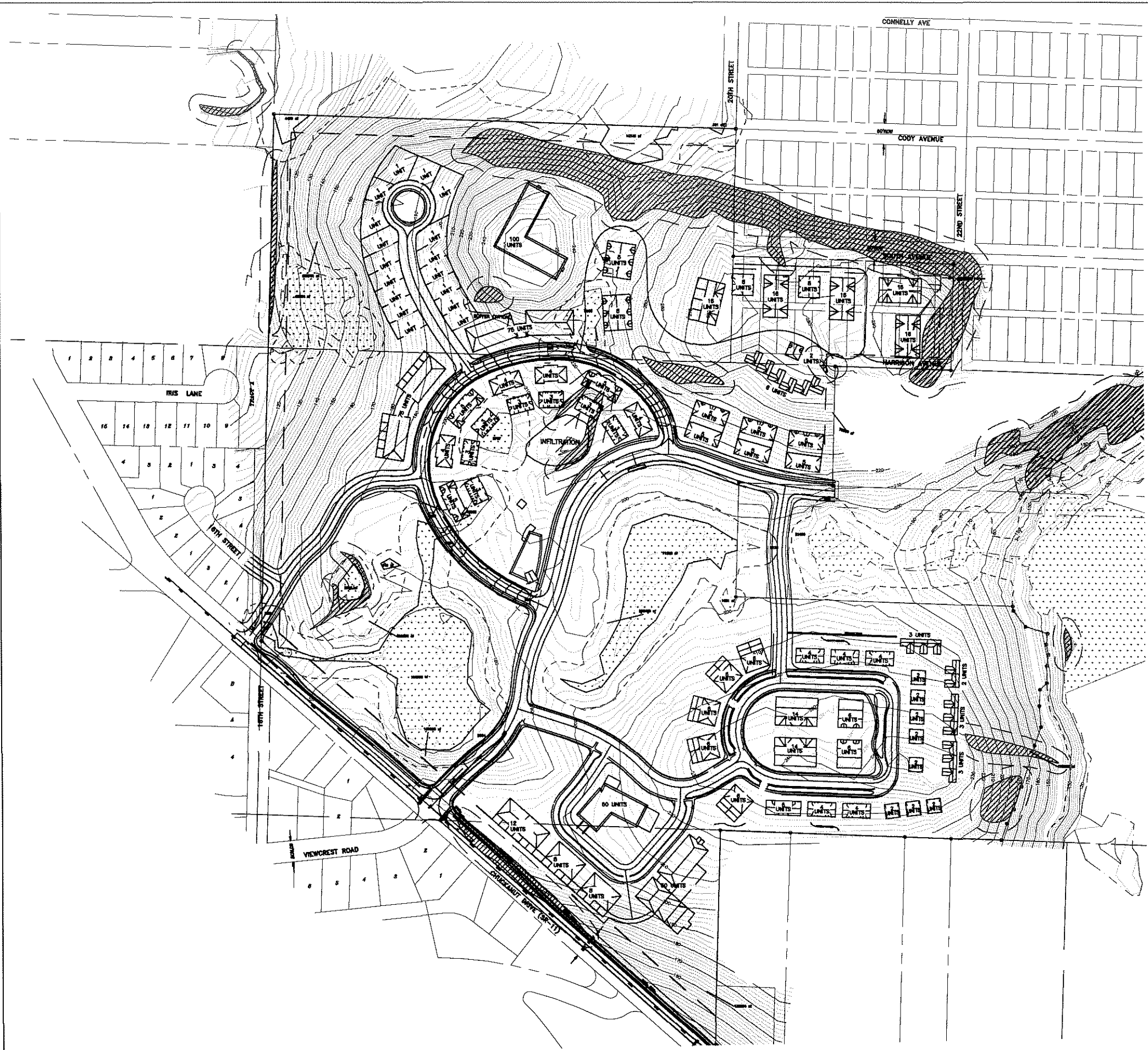
Alternative 2A with Slope Impacts

Proposed Fairhaven Highlands Development  
Bellingham, Washington

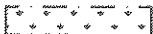
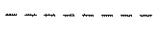




Figure 7

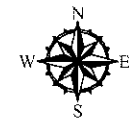
W:\BELLINGHAM\PROJECTS\11911001\02\CAD\1191100102 Fig 8.dwg\TAB:LANDSCAPE MODIFIED BY THICHAUD ON FEB 12, 2009 - 10:13



**Legend**


-  Wetland
-  Wetland Buffer
-  Area of 40% Slope or Greater
-  30' Slope Buffer

DRAFT

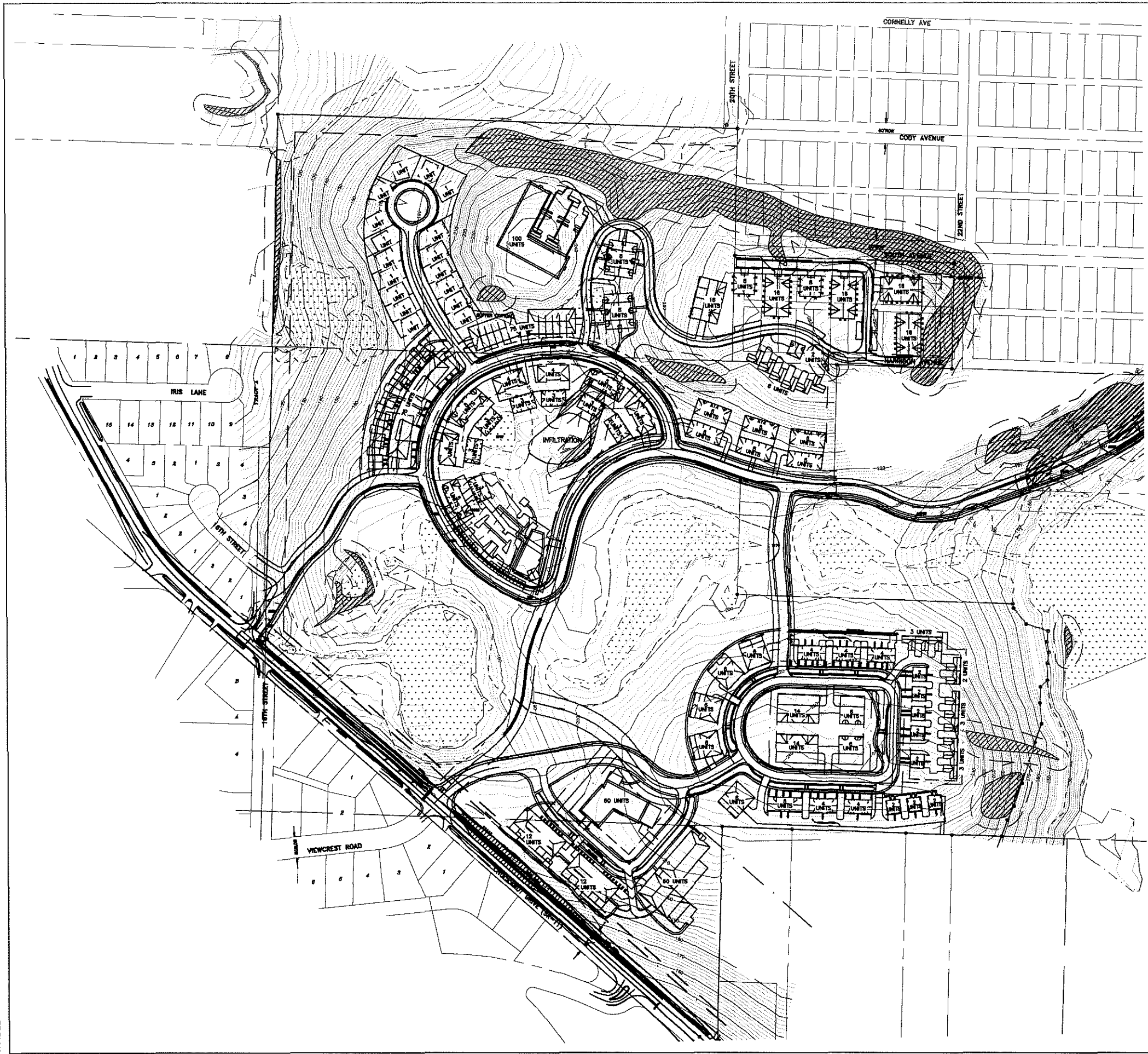


**Notes**



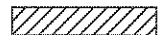

1. Geologic conditions inferred from subsurface exploration, site reconnaissance, and topographic features.
2. The locations of all features shown are approximate.
3. This drawing is for information purposes. It is intended to assist in showing features discussed in an attached document.  
GeoEngineers, Inc. cannot guarantee the accuracy and content of electronic files. The master file is stored by GeoEngineers, Inc. and will serve as the official record of this communication.  
Reference: p-lay-ALT-2F.dwg provided by Ronald T. Jepson & Assoc.

<b>Alternative 2F with Slope Impacts</b>	
Proposed Fairhaven Highlands Development Bellingham, Washington	
<b>GEOENGINEERS</b> 	Figure 8

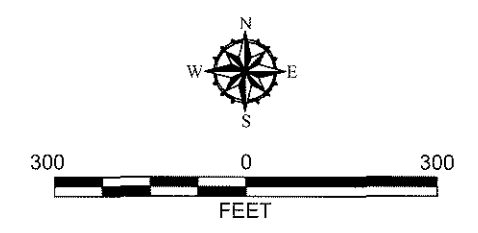
W:\BELLINGHAM\PROJECTS\11\1911001\02\CAD\1191100102 Fig 9.dwg\TAB:LANDSCAPE MODIFIED BY TMICHAUD ON FEB 12, 2009 - 10:11



**Legend**


-  Wetland
-  Wetland Buffer
-  Area of 40% Slope or Greater
-  30' Slope Buffer

DRAFT

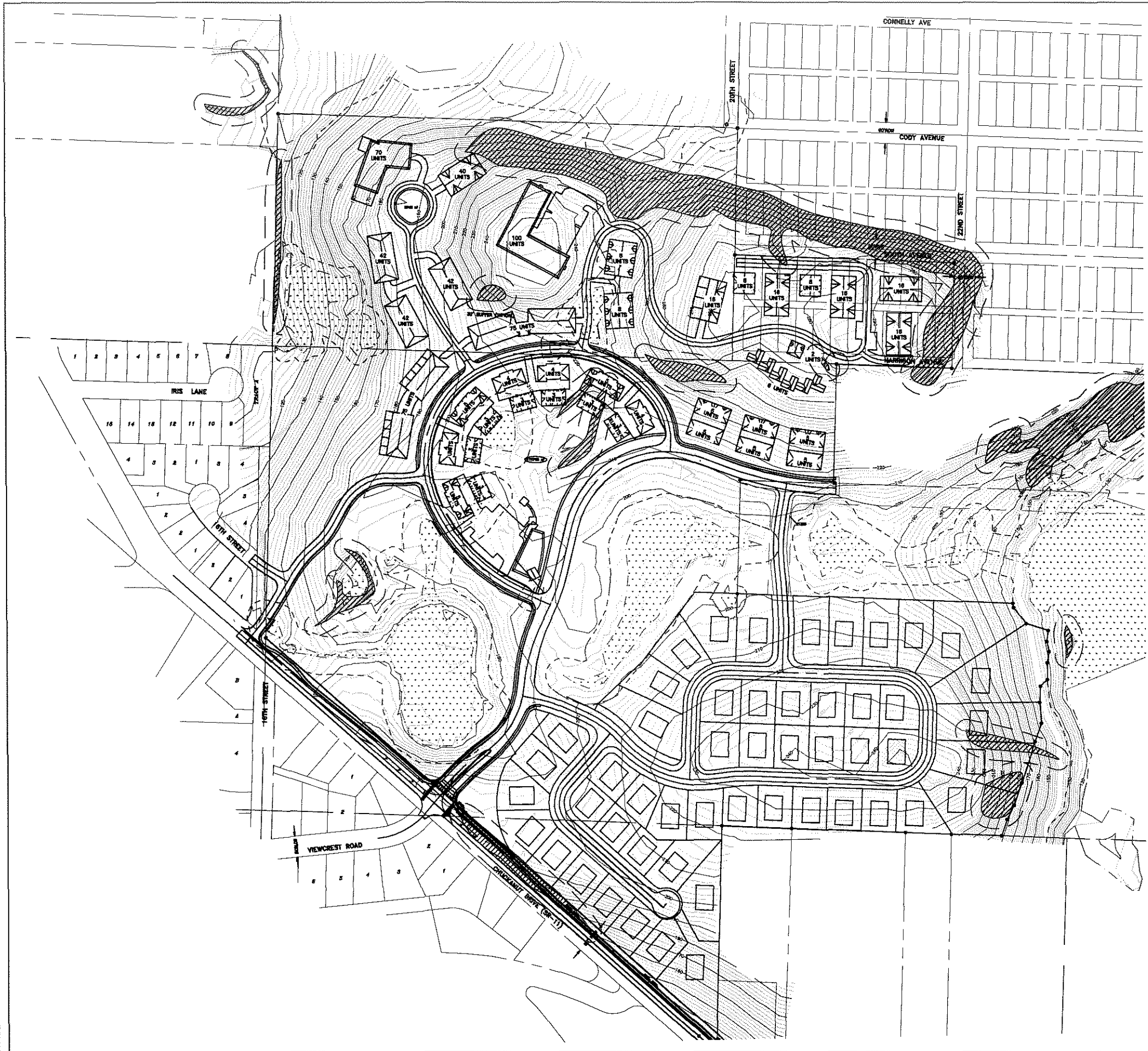


**Notes**

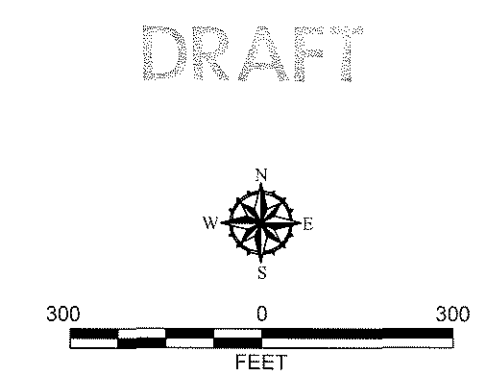
1. Geologic conditions inferred from subsurface exploration, site reconnaissance, and topographic features.
2. The locations of all features shown are approximate.
3. This drawing is for information purposes. It is intended to assist in showing features discussed in an attached document.  
GeoEngineers, Inc. cannot guarantee the accuracy and content of electronic files. The master file is stored by GeoEngineers, Inc. and will serve as the official record of this communication.  
Reference: p-lay-ALT-3D.dwg provided by Ronald T. Jepson & Assoc.

<b>Alternative 3D with Slope Impacts</b>	
Proposed Fairhaven Highlands Development Bellingham, Washington	
<b>GEOENGINEERS</b> 	<b>Figure 9</b>

W:\BELLINGHAM\PROJECTS\11\1911001\02\CAD\191100102 Fig 10.dwg\TAB:LANDSCAPE MODIFIED BY THICHAUD ON FEB 12, 2009 - 13:42



- Legend**
- Wetland
  - Wetland Buffer
  - Area of 40% Slope or Greater
  - 30' Slope Buffer



**Notes**

1. Geologic conditions inferred from subsurface exploration, site reconnaissance, and topographic features.
2. The locations of all features shown are approximate.
3. This drawing is for information purposes. It is intended to assist in showing features discussed in an attached document.  
GeoEngineers, Inc. cannot guarantee the accuracy and content of electronic files. The master file is stored by GeoEngineers, Inc. and will serve as the official record of this communication.  
Reference: p-lay-ALT-4F.dwg provided by Ronald T. Jepson & Assoc.

<b>Alternative 4F with Slope Impacts</b>	
Proposed Fairhaven Highlands Development Bellingham, Washington	
<b>GEOENGINEERS</b>	Figure 10