

DRAFT

Map Revised: February 12, 2009

Office: BAM Path: P:\11\191100102\GIS\1191100102\_FIG-1.mxd

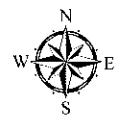
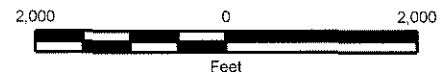
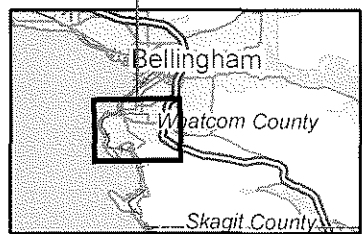
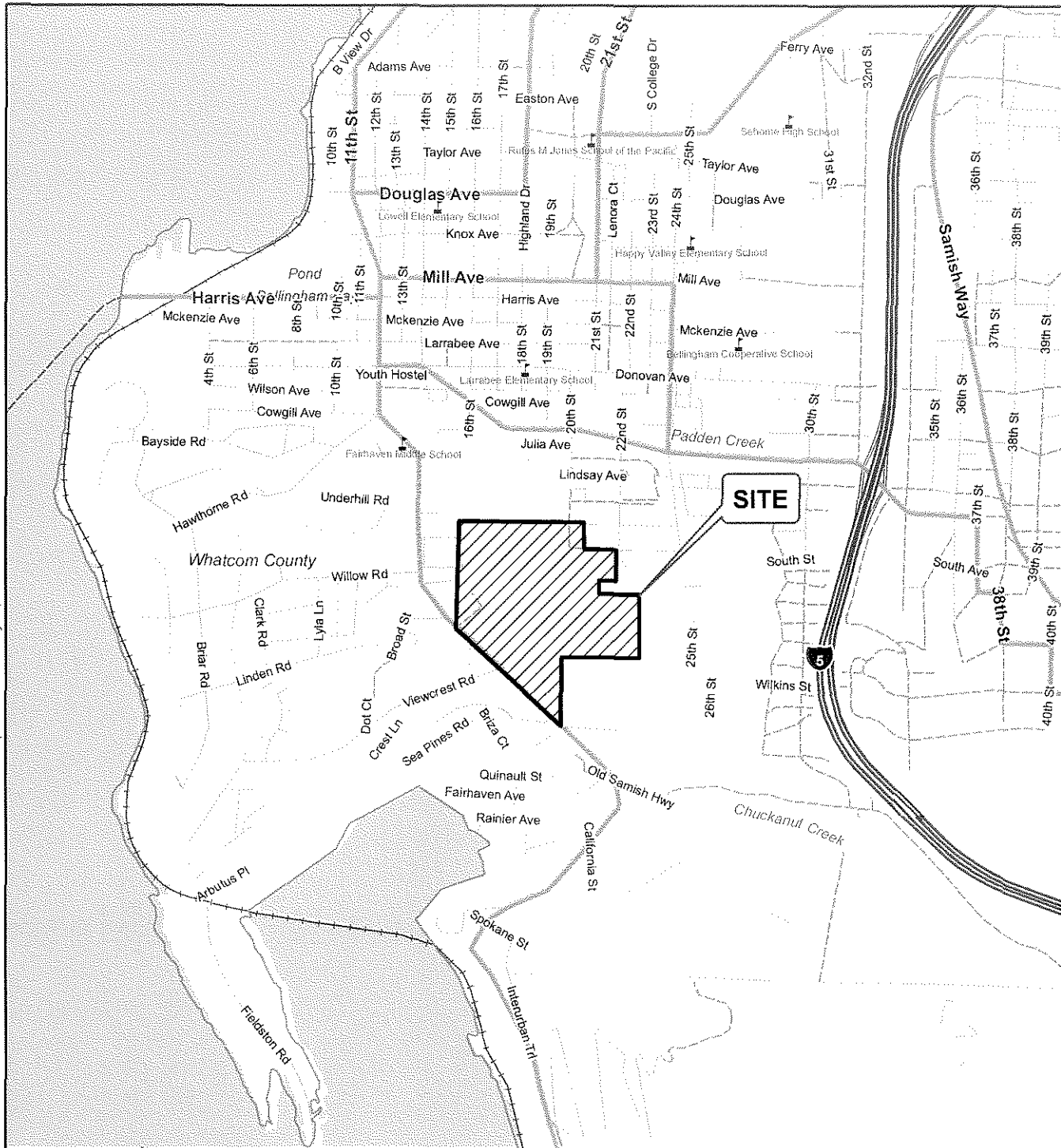

<b>Vicinity Map</b>	
Proposed Fairhaven Highlands Development Bellingham, Washington	
	<b>Figure 1</b>

Reference: ESRI Streets and Map Data, 2005.



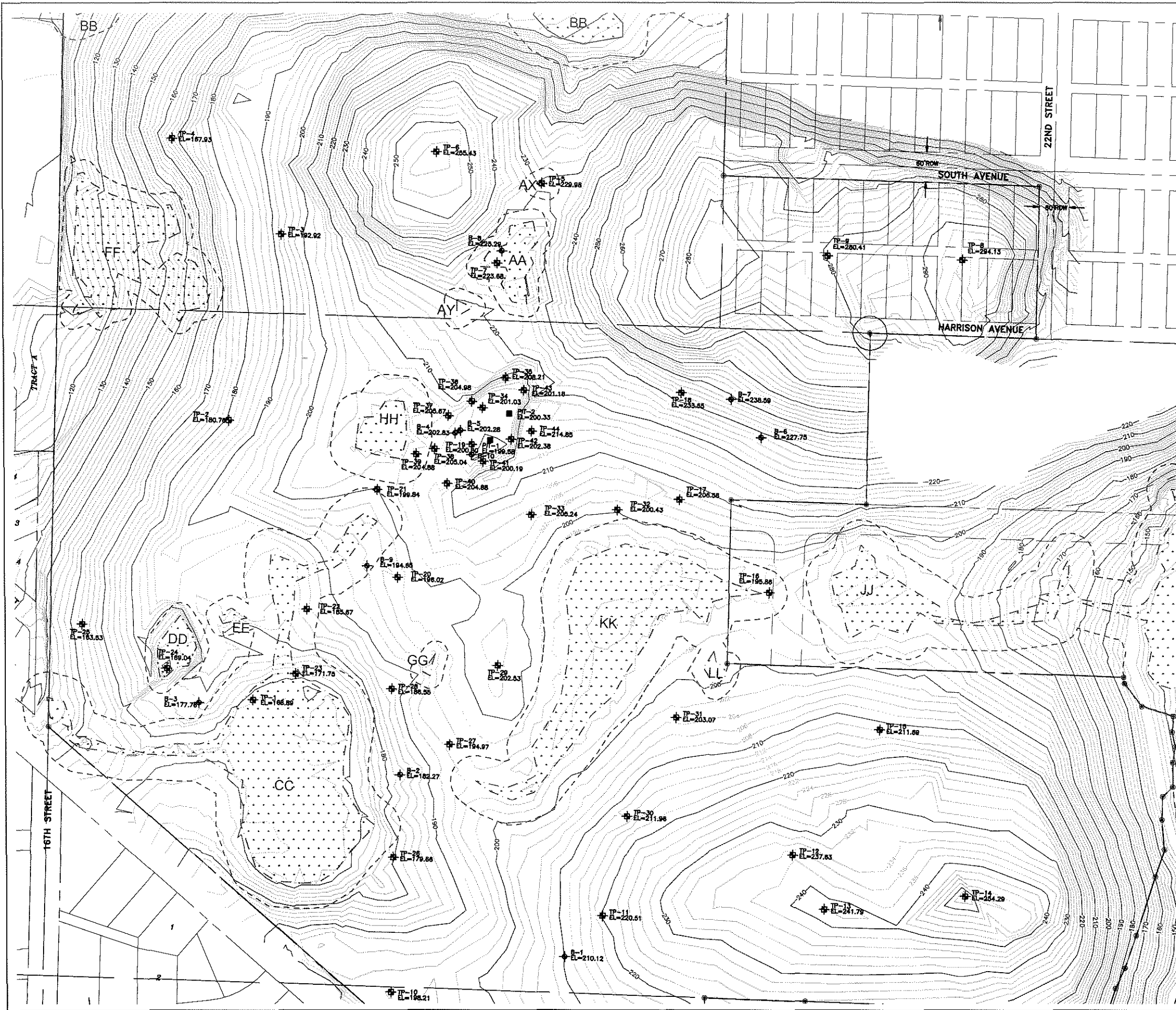

Notes:

1. The locations of all features shown are approximate.
2. This drawing is for information purposes. It is intended to assist in showing features discussed in an attached document. GeoEngineers, Inc. can not guarantee the accuracy and content of electronic files. The master file is stored by GeoEngineers, Inc. and will serve as the official record of this communication.

W:\BELLINGHAM\PROJECTS\11\1191001\02\CAD\119100102 Fig 2.DWG\TAB.LANDSCAPE MODIFIED BY THICHAUD ON FEB 12, 2009 - 13:39

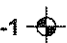

**Legend**

- B-1  Boring number and approximate location
- TP-1  Test Pit number and approximate location
- PIT-1  Pilot Infiltration Test
-  Wetland Edge
-  Wetland Buffer

**DRAFT**

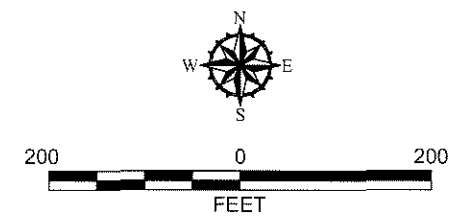

**Notes**

1. The locations of all features shown are approximate.
  2. This drawing is for information purposes. It is intended to assist in showing features discussed in an attached document. GeoEngineers, Inc. cannot guarantee the accuracy and content of electronic files. The master file is stored by GeoEngineers, Inc. and will serve as the official record of this communication.
- Reference: Test-pit.dwg dated 1-27-09 provided by Ronald T. Jepson & Assoc.

<b>Existing Site Conditions and Subsurface Explorations</b>	
Proposed Fairhaven Highlands Development Bellingham, Washington	
<b>GEOENGINEERS</b> 	Figure 2

W:\BELLINGHAM\PROJECTS\1191001\02\CAD\119100102 Fig 3.dwg\TAB.LANDSCAPE MODIFIED BY THICHAUD ON FEB 12, 2009 - 8:33

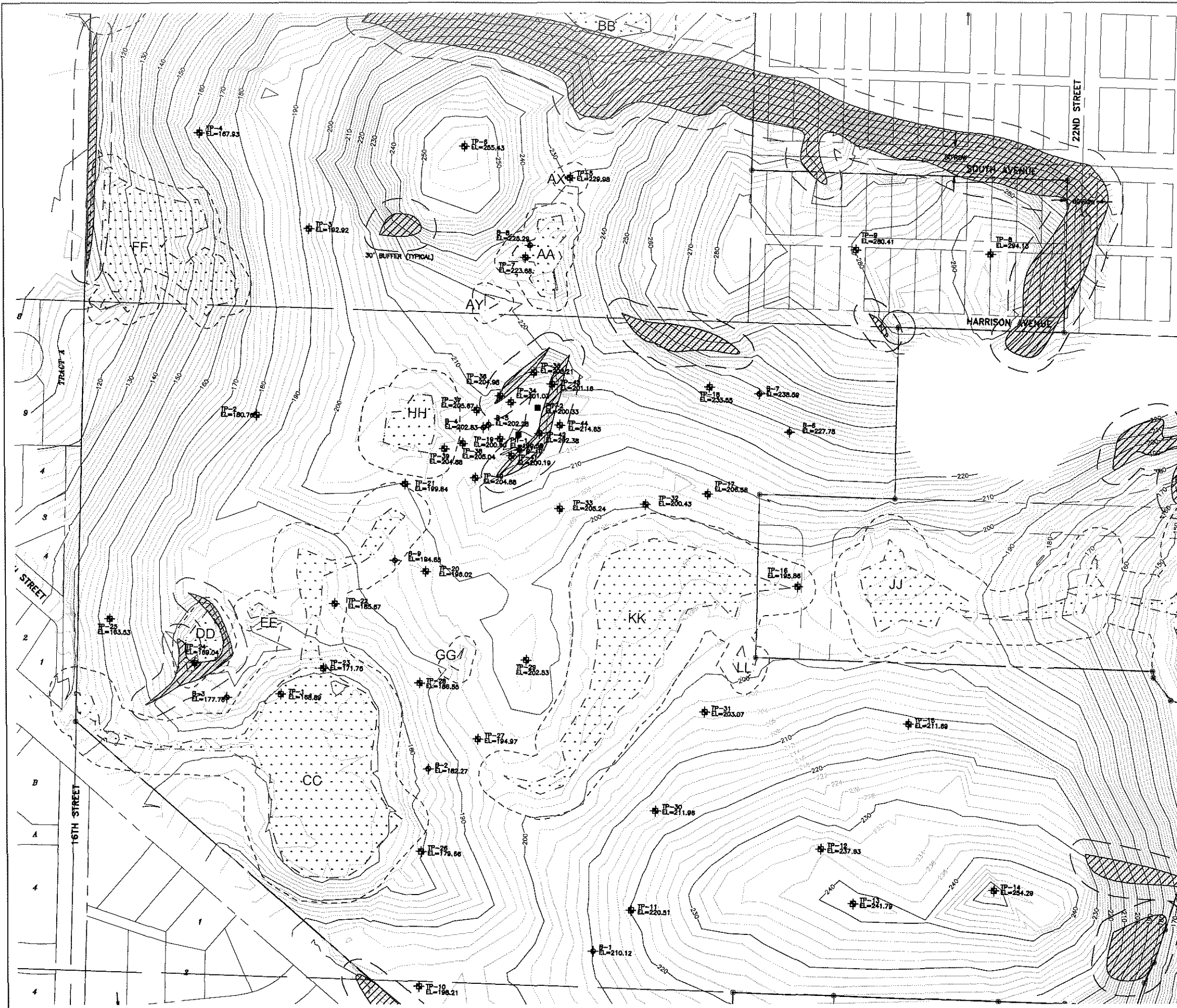

**Legend**

- B-1 Boring number and approximate location
- TP-1 Test Pit number and approximate location
- PIT-1 Pilot Infiltration Test
- Wetland
- Wetland Buffer
- Area of 40% Slope or Greater
- 30' Slope Buffer

**DRAFT**

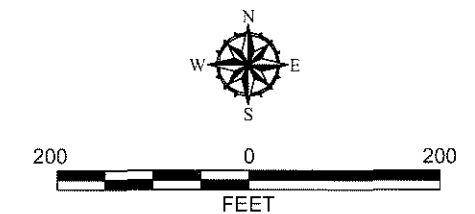

**Notes**

1. The locations of all features shown are approximate.
  2. This drawing is for information purposes. It is intended to assist in showing features discussed in an attached document. GeoEngineers, Inc. cannot guarantee the accuracy and content of electronic files. The master file is stored by GeoEngineers, Inc. and will serve as the official record of this communication.
- Reference: Test-pit.dwg dated 1-27-09 provided by Ronald T. Jepson & Assoc.

<b>Existing Site Conditions with Subsurface Explorations and Areas with 40 Percent Slopes or Greater</b>	
Proposed Fairhaven Highlands Development Bellingham, Washington	
<b>GEOENGINEERS</b>	Figure 3

W:\BELLINGHAM\PROJECTS\11\191001\02\CAD\119100102\Fig 5.dwg\TAB:LANDSCAPE MODIFIED BY TRICHAUD ON FEB 12, 2009 - 10:25



**Legend**

- Wetland
- Wetland Buffer
- Area of 40% Slope or Greater
- 30' Slope Buffer

DRAFT

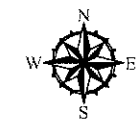

**Notes**

1. Geologic conditions inferred from subsurface exploration, site reconnaissance, and topographic features.
2. The locations of all features shown are approximate.
3. This drawing is for information purposes. It is intended to assist in showing features discussed in an attached document.  
GeoEngineers, Inc. cannot guarantee the accuracy and content of electronic files. The master file is stored by GeoEngineers, Inc. and will serve as the official record of this communication.  
Reference: p-lay-ALT-1C.dwg provided by Ronald T. Jepson & Assoc.

**Alternative 1A with Slope Impacts**

Proposed Fairhaven Highlands Development  
Bellingham, Washington







Figure 5

W:\BELLINGHAM\PROJECTS\11\191001\02\CAD\11\19100102\Fig 6.dwg\TAB:LANDSCAPE MODIFIED BY TRICHAUD ON FEB 12, 2009 - 10:17



**Legend**

-  Wetland
-  Wetland Buffer
-  Area of 40% Slope or Greater
-  30' Slope Buffer

DRAFT

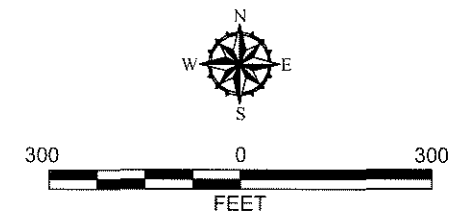

**Notes**

1. Geologic conditions inferred from subsurface exploration, site reconnaissance, and topographic features.
2. The locations of all features shown are approximate.
3. This drawing is for information purposes. It is intended to assist in showing features discussed in an attached document.  
GeoEngineers, Inc. cannot guarantee the accuracy and content of electronic files. The master file is stored by GeoEngineers, Inc. and will serve as the official record of this communication.  
Reference: p-lay-ALT-1C.dwg provided by Ronald T. Jepson & Assoc.

**Alternative 1C with Slope Impacts**

Proposed Fairhaven Highlands Development  
Bellingham, Washington



Figure 6