

- SITE IMPROVEMENTS**
 SITE = 3,583,547 SF / 82.27 ACRES
- FOREST = 1,108,948 SF / 25.48 ACRES
 - NON-POLLUTION GENERATING IMPERVIOUS = 490,709 SF / 11.27 ACRES
 - POLLUTION GENERATING IMPERVIOUS = 422,854 SF / 9.70 ACRES
 - WETLAND = 245,365 SF / 5.63 ACRES
 - LANDSCAPE = 1,315,871 SF / 30.21 ACRES

NOTE:
 NON-POLLUTION GENERATING IMPERVIOUS INCLUDES ROOFS, SIDEWALKS, AND STORMWATER PONDS

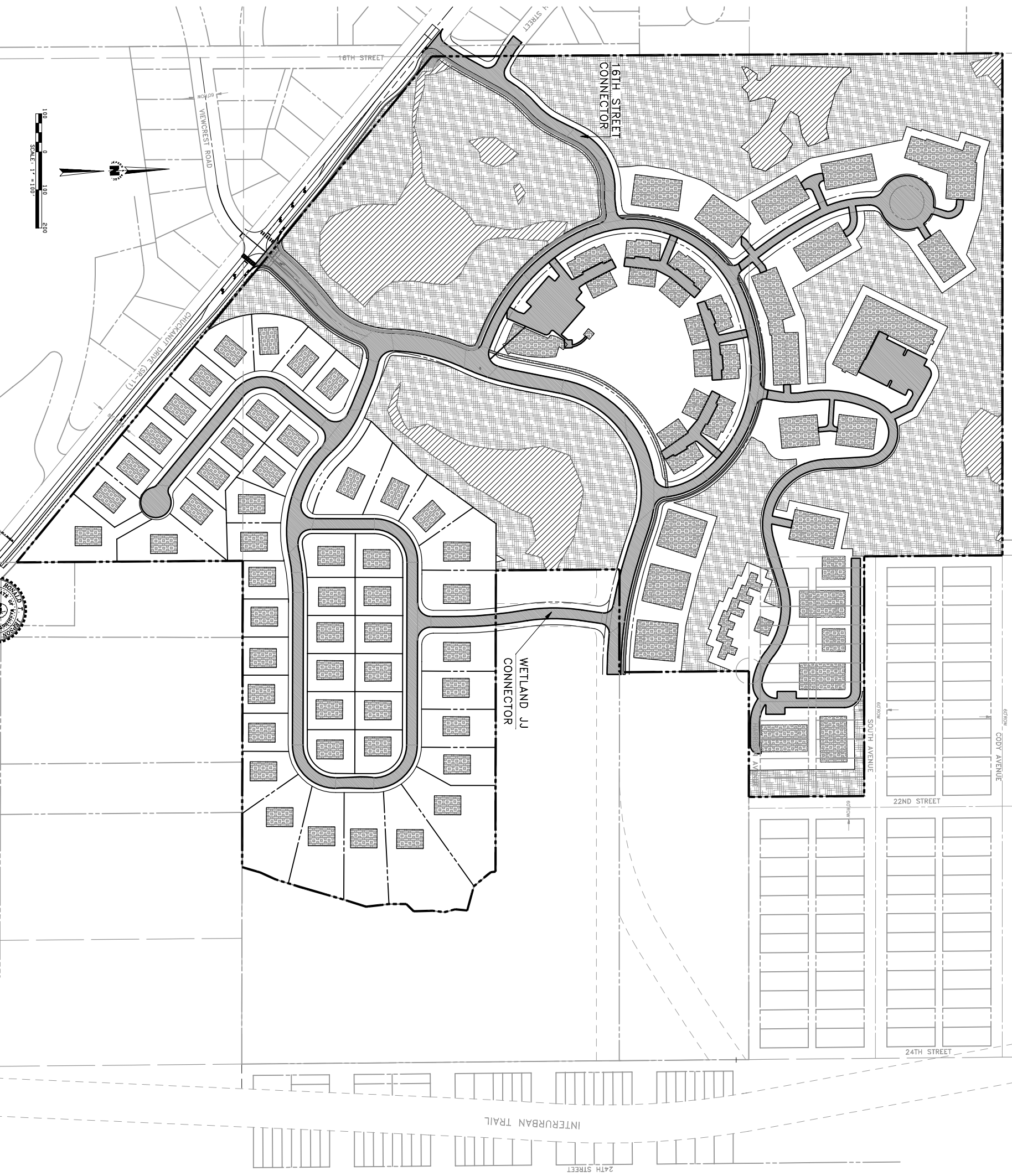

RONALD T. JEPSON & ASSOCIATES
 REGISTERED PROFESSIONAL ENGINEERS AND LAND SURVEYORS
 222 GRAND AVE., SUITE C, BELLINGHAM, WASHINGTON 98225 PH: (360) 733-5780 FAX: (360) 647-8838

PROJECT NO.	17-100
DRAWN BY	AW
CHECKED BY	AW
DATE	4/12/2009

DATE	1/26/2009
------	-----------



ALTERNATIVE 4F LAND COVER
 FAIRHAVEN HIGHLANDS (729 UNITS)
 CHUCKCHANI DRIVE, FAIRHAVEN

CLIENT:
 GREENBRIAR NORTHWEST, LLC

4F-3

04127